

DIMENSIONS TABLE

NOMINAL SIZE		d		FLANGED END							SOCKET END					THREADED END				SPIGOT END															
				DIN PN10				PVC, C-PVC			PP, PVDF		PVC				PP, PVDF																		
				D	C	n	h														L	t	H1	d1	l	L	H1	d2	l	L	H1	d3	d3'	l	L
65mm	2 1/2"	78	58	185	145	4	18	304	18	256	75	44	282	245	74.25	73.95	31	256	227	Rp 21/2	32	264	235	-	-	-	-	-	-	-	-	-	-	-	-
80	3	78	58	200	160	8	18	310	21	259	90	51	282	245	89.20	88.85	35.5	251	224	Rp 3	35	264	235	90	80	51	299	252	90	38	8.2	4.3	295	246	
100	4	100	78	220	180	8	18	350	18	305	110	61	349	305	109.05	108.65	41.5	310	279	Rp 4	45	338	299	110	93.6	46	358	308	110	44.5	10.0	5.3	353	301	

Unit:mm

NOMINAL SIZE	D1	H	A	A2	A3	A3'	P	ACTUATOR TYPE
65mm	2 1/2"	152	247	438	58.5	59	69	1/4 AR070NC40SN
80	3	152	247	438	58.5	59	69	1/4 AR070NC40SN
100	4	210	349	569	82	82	92	1/4 AR100NC22SN

FLANGED END

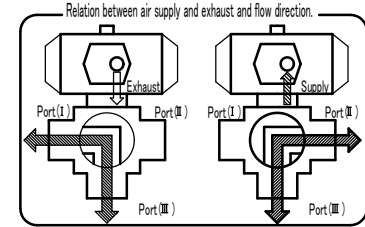
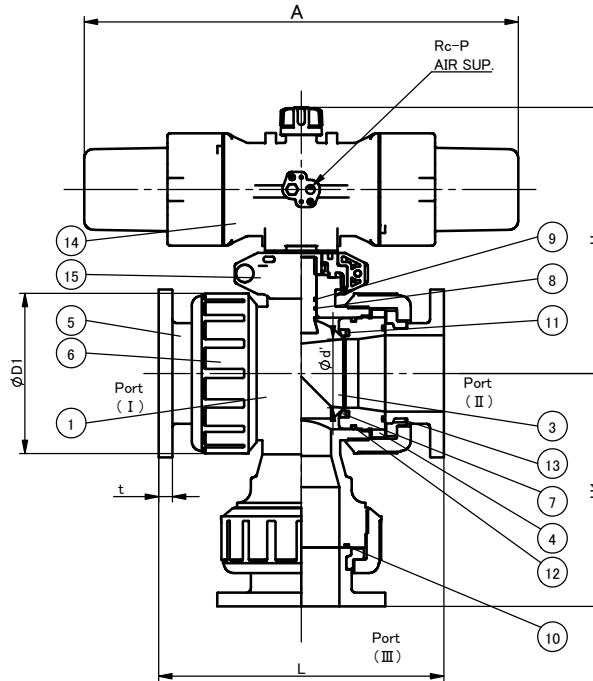
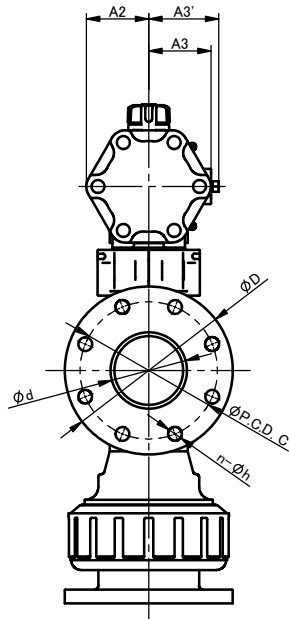

NOTE.

1. Operating pressure: 0.4MPa~0.7MPa G

- Air to open :Port II ↔ III :Air supply
- :Port I ↔ III :Air exhaust
- Air to shut :Port II ↔ III :Air exhaust
- :Port I ↔ III :Air supply

2.The shape and appearance of assembly differ a little with nominal size compared to this drawing.

16	JOINT	1	SUS304(STAINLESS STEEL)	
15	STAND	1	PPG etc.	
14	ACTUATOR	1	PPG etc.	
13	STOP RING	3	PVDF	
12	O-RING	2	□EPDM □FKM □Others	
11	CUSHION	2		
10	O-RING	3		
9	O-RING	1		
8	O-RING	1		
7	SEAT	2	PTFE	
6	UNION NUT	3		
5	END CONNECTOR	3	□PVC □C-PVC □PP □PVDF	
4	CARRIER	2		
3	BALL	1		
2	STEM	1		
1	BODY	1		
No.	DESCRIPTION	QTY.	MATERIAL	REMARKS

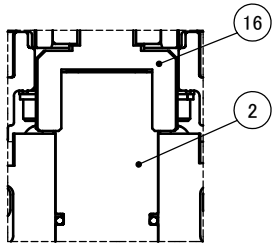

Used for 100mm (4") only.

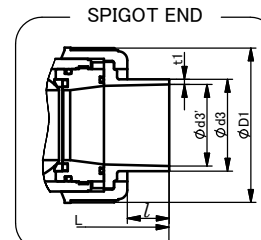
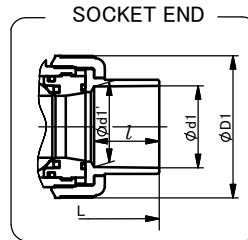
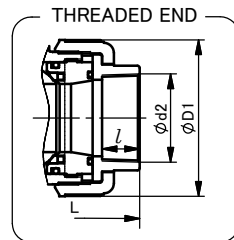

ITEM	3-WAY BALL VALVE TYPE 23 PNEUMATIC MODEL TYPE AR Ass'y □AIR TO OPEN, □AIR TO SHUT DOUBLE L-PORT DIN : □FLANGED END, □SOCKET END, □THREADED END, □SPIGOT END 65mm (2 1/2") ~ 100mm (4") OPTION: -		
------	---	--	--

DRAWN	A. Yamamizu	DATE	SCALE
CHECKED	S. shimazak	Apr. 1, 2026	~
APPROVED	A. Shakagori	DRAWING No. T3-AA080DE	
SPECIAL ORDER No.	ASAHI YUKIZAI CORPORATION		